

## ARAG 2 & 3-WAY MANUAL BALL VALVES

Arag Ball Valves feature fibreglass reinforced polypropylene bodies, Teflon ball and seals, female threads and three threaded mountings. 3-Way H models are continuous flow.



4542135



4542236



4542235H

ARAG Standard Flow 3-WAY Ball Valve:

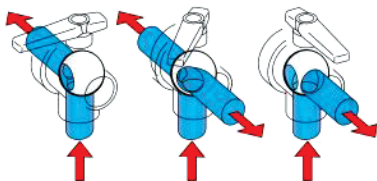
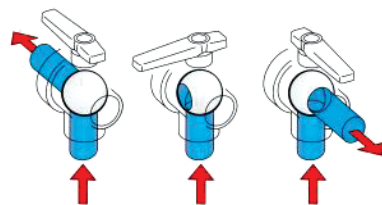

ARAG Continuous Flow (H) 3-WAY Ball Valve:

| PART No.                                      | DESCRIPTION                       |
|---|-----------------------------------|
| 4542132                                       | 2-Way Ball Valve 1/2", 16 Bar     |
| 4542133                                       | 2-Way Ball Valve 3/4", 16 Bar     |
| 4542134                                       | 2-Way Ball Valve 1", 16 Bar       |
| 4542135                                       | 2-Way Ball Valve 1-1/4", 10 Bar   |
| 4542136                                       | 2-Way Ball Valve 1-1/2", 10 Bar   |
| 4542137                                       | 2-Way Ball Valve 2", 10 Bar       |
| <b>Standard Flow 3-Way Ball Valves:</b>       |                                   |
| 4542232                                       | 3-Way Ball Valve 1/2", 16 Bar     |
| 4542233                                       | 3-Way Ball Valve 3/4", 16 Bar     |
| 4542234                                       | 3-Way Ball Valve 1", 10 Bar       |
| 4542235                                       | 3-Way Ball Valve 1-1/4", 10 Bar   |
| 4542236                                       | 3-Way Ball Valve 1-1/2", 10 Bar   |
| 4542237                                       | 3-Way Ball Valve 2", 10 Bar       |
| <b>Continuous Flow (H) 3-Way Ball Valves:</b> |                                   |
| 4542232H                                      | 3-Way H Ball Valve 1/2", 16 Bar   |
| 4542233H                                      | 3-Way H Ball Valve 3/4", 16 Bar   |
| 4542234H                                      | 3-Way H Ball Valve 1", 16 Bar     |
| 4542235H                                      | 3-Way H Ball Valve 1-1/4", 10 Bar |
| 4542236H                                      | 3-Way H Ball Valve 1-1/2" 10 Bar  |
| 4542237H                                      | 3-Way H Ball Valve 2" 10 Bar      |

## KNIFE VALVES

- Polypropylene slide
- Stainless steel stem
- PTFE seals
- Seals in Vitona®
- Body in polypropylene reinforced with fibreglass

| PART No. | DESCRIPTION                |
|----------|----------------------------|
| 450025   | 1-1/4" Male/Female Threads |
| 450026   | 1-1/2" Male/Female Threads |
| 450027   | 2" Male/Female Threads     |

